

**MIRAFLEX III PEDESTRIAN WATERPROOF DECKING SYSTEM**
**PLYWOOD SUBSTRATE AT WOOD OR METAL STUD WALL DETAIL**

THESE DETAILS ARE FOR REFERENCE ONLY AND MUST BE REVIEWED BY A DESIGN PROFESSIONAL

\*\*\*NOT TO SCALE\*\*\*

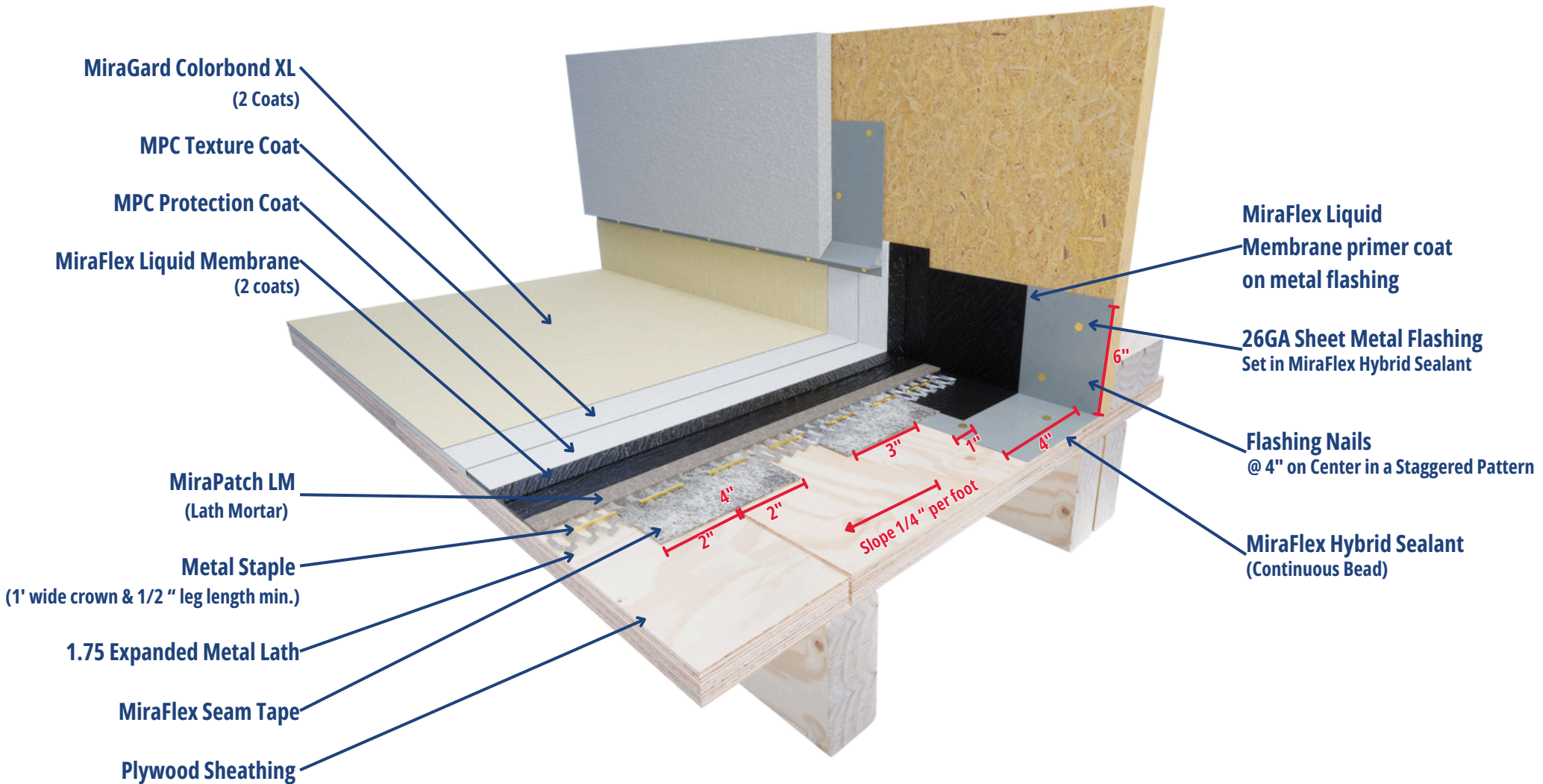

**Plywood:** Exterior grade minimum 5/8" sheathing fully blocked, glued and screwed, no deflection.

**Important:** Consult Crossfield Products Corp. for additional information regarding plywood sheathing, framing/blocking, deck drain types etc.