

NOTES

1. MECHANICALLY PREPARE CONCRETE SURFACES IN ACCORDANCE WITH ICRI 03732 TO ACHIEVE A CONCRETE SURFACE PROFILE OF CSP-3 OR HIGHER, OR AS PER MANUFACTURER’S REQUIREMENTS.
2. INSTALL CANT BEAD OF POLYURETHANE SEALANT AT VERTICAL TRANSITION, AS PER SEALANT MANUFACTURER’S RECOMMENDATIONS. TOOL FLUSH/SPRINKLE OVEN DRIED SAND IMMEDIATELY INTO SEALANT SURFACE WHILE TACKY. ALLOW TO CURE MINIMUM 24 HRS, OR AS REQUIRED.
3. INSTALL MIRACOTE MPC DECK COATING IN ACCORDANCE WITH SPECIFICATIONS AND MANUFACTURER’S INSTALLATION GUIDELINES.

Miracote MPC System – ———

- Pedestrian Traffic – 2 Coat System (60 mils minimum)
- Vehicular Traffic – 3 Coat System (90 mils minimum)

Concrete Surface Preparation - - - -

- Concrete surface profile of CSP-3 or higher
- Saturated Surface Dry (SSD) substrate

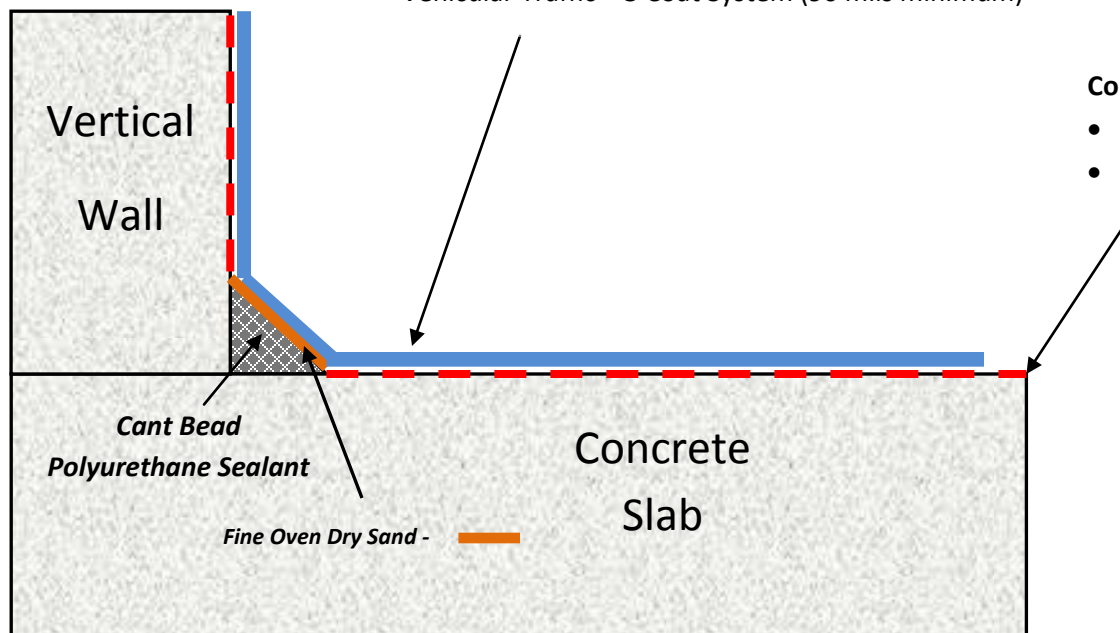

MIR.-MPC-SWT1

SLAB-TO-WALL TRANSITION



Division of Crossfield Products Corp.

05/18/2009

NTS

Miracote MPC Deck Coating